

THE
STRIDE
STRATA OFFICE



BUKIT BINTANG
CITY CENTRE

ALL THAT YOU NEED, EVERYTHING THAT YOU DESIRE

Destined to be the new heartbeat of Kuala Lumpur, Bukit Bintang City Centre (BBCC) is a visionary, state-of-the-art integrated development designed to complement and enhance the city's cosmopolitan vibe. Offering extraordinary spaces for business, retail, entertainment and life, the 19.4-acre BBCC promises to light up the Golden Triangle.



BUKIT BINTANG
CITY CENTRE



A Joint Development By:



CONNECTED TO THE WORLD

BBCC is designed to welcome visitors from all corners of the globe. At the same time, BBCC will connect the city to the world via an annexed transit hub that will encompass the existing Hang Tuah monorail and LRT stations, as well as provide linkage to the upcoming Merdeka MRT station. The proposed High Speed Rail station will be just few stops away via the LRT.

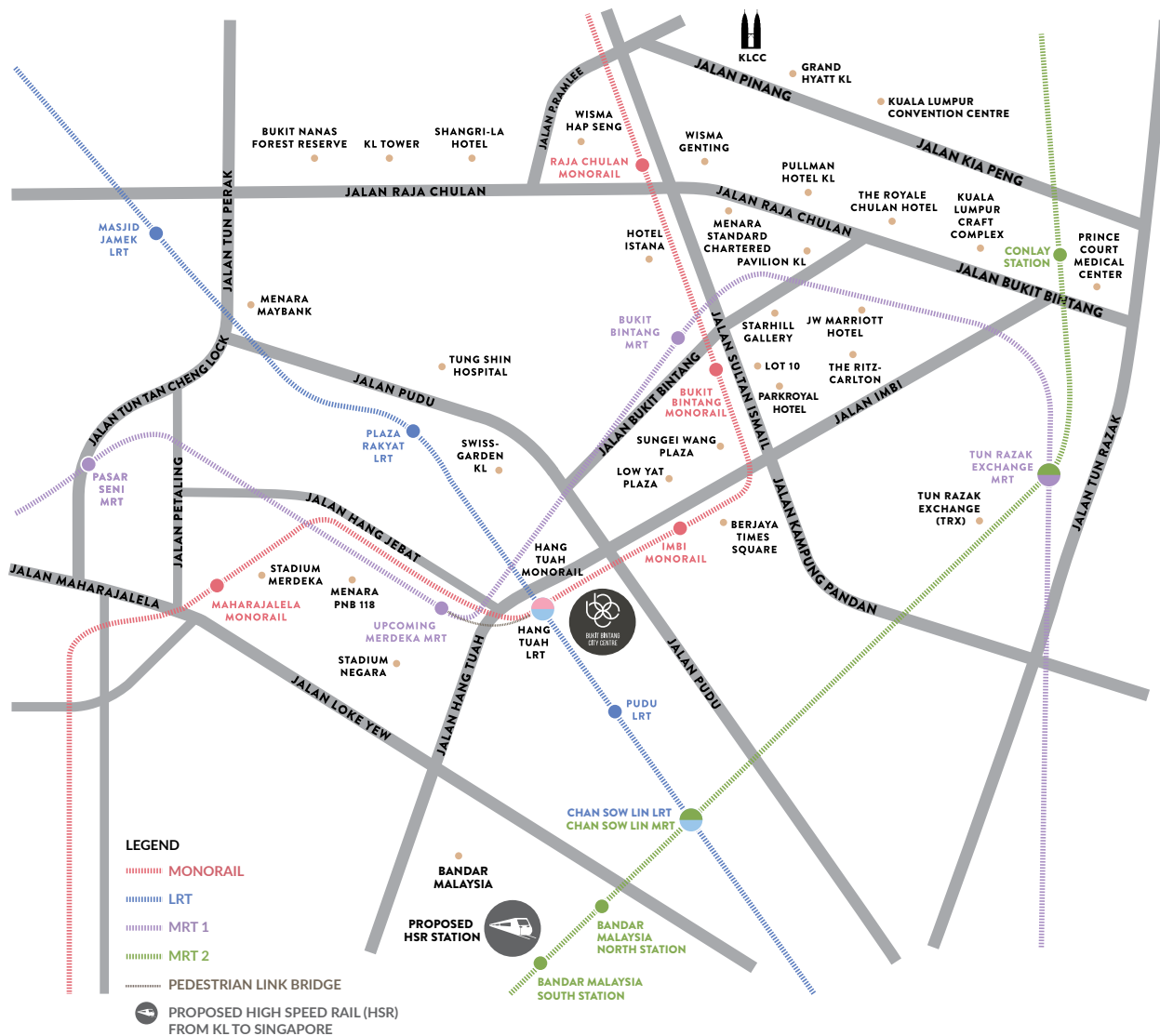

Enjoy our world-class services and expert assistance every day.
BBCC Development Sdn Bhd 11292877
No. 2, Jalan Hang Tuah, 53100 Kuala Lumpur
P: +603 2117 2255 E: info@bbckl.com
GPS: 3.141656, 101.707755
Monday to Friday 9am - 6pm
Weekends & Public Holidays 10am - 6pm



+603 2117 2255
www.bbckl.com

Development Manager:

ECOWORLD
CREATING TOMORROW & BEYOND
Ecoworld Development Management (BBCC) Sdn Bhd (09643194)
(Formerly known as Eco World Development Management Sdn Bhd)

All art renderings and photographs contained in this circular are artist's impression only. The Developer reserves the right to modify any part or parts of the building prior to completion as directed or approved by the architects and/or the relevant authorities. All plans, layout, information and specifications are subject to change and cannot form part of an offer or contract presentation.



STRIDE AHEAD TO AN ICONIC BUSINESS ADDRESS

The Stride is a strata office tower in Bukit Bintang City Centre (BBCC). With its asymmetrical, trapezoid profile, it is an emblem of corporate sophistication wrapped in visionary architecture. At 46 levels high and overlooking the bright lights of BBCC and Kuala Lumpur, it offers the perfect vantage point from which to gain a visionary world view.

BREATHTAKING GRANDEUR

From the moment of arrival, The Stride makes a powerful first impression that continues within. In the grand reception lobby, the striking feature walls and lofty ceiling are complemented by neutral tones and rich materials to create an elegant corporate ambience.







BUSINESS LOUNGE



BUSINESS FACILITIES RECEPTION

TAKING THE ART OF DOING BUSINESS TO NEW HEIGHTS

A business address at The Stride is your entrée to a new world of corporate excellence that includes an array of professionally managed business conveniences comprising reception services, a business lounge, conference room, meeting rooms and video conferencing facilities.

(Business Facility Floor Layout shown on this page is subject to change without notice and may be varied, modified and/or substituted in accordance to the requirements of the professional business facilities manager. The business facilities on Level 6 and Level 6-M do not form part of the common facilities. Usage of the business facilities will be subject to the terms and conditions as determined by the professional business facilities manager.)

VERSATILE AND FUNCTIONAL SPACES

The Stride offers office suites with floor areas ranging from 1,087 sq. ft. to 1,187 sq. ft.

TYPICAL FLOOR PLAN

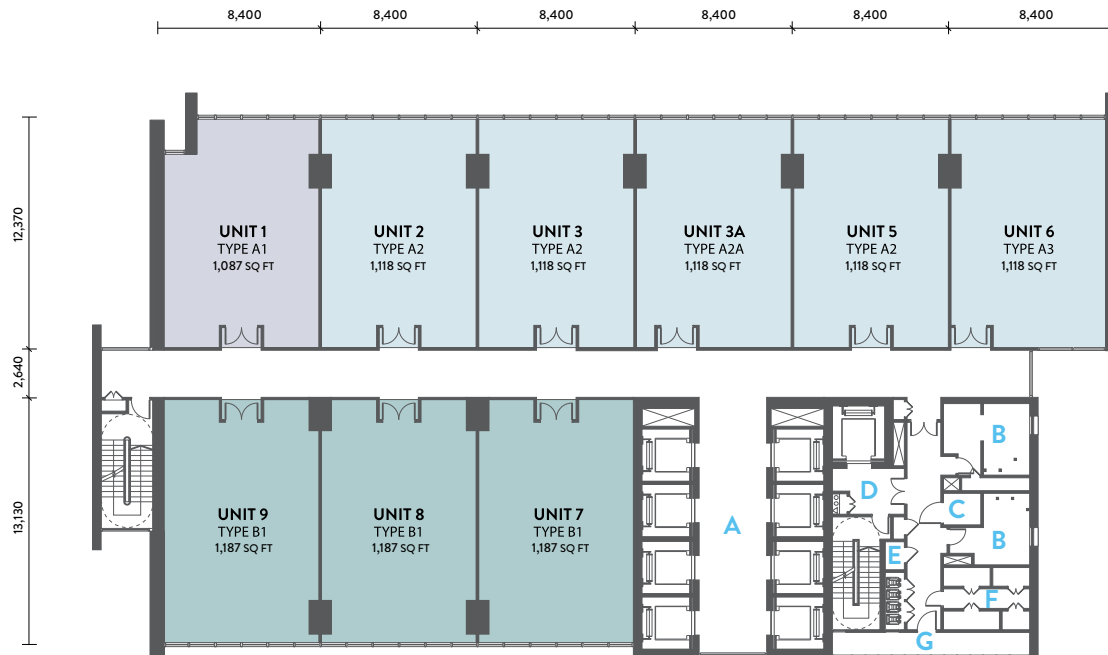

LEGEND

- | | | | |
|--------------|---------------------|------------|-------------|
| A Lift Lobby | C Disabled Washroom | E Riser | G A/C Ledge |
| B Washroom | D Service Lift | F M&E Room | |



COMPREHENSIVE SHARED MEETING FACILITIES